

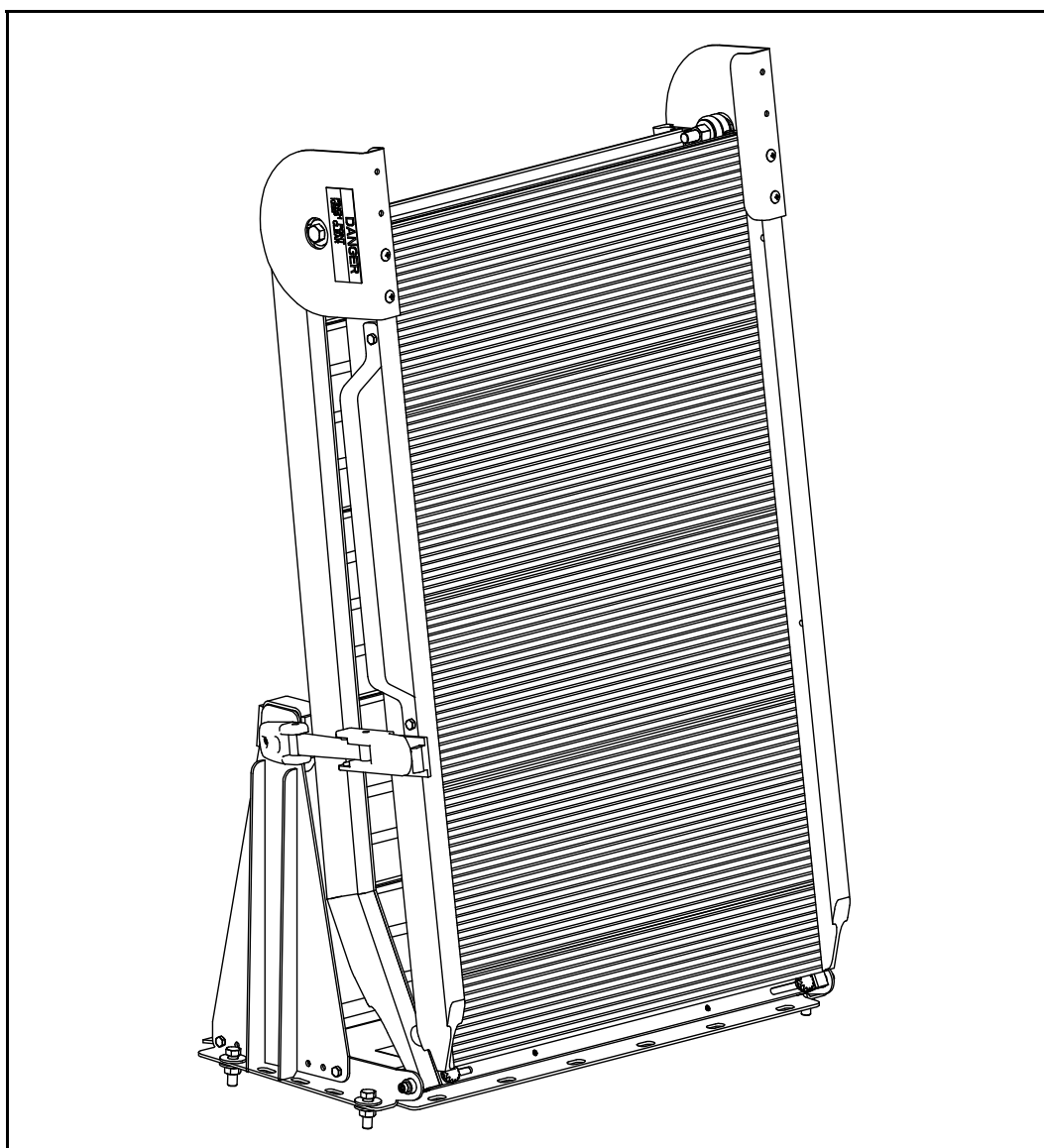

# INSTALLATION INSTRUCTIONS

## LB20 SERIES RAMPS



Link Mfg. Ltd.  
223 15th St. N.E.  
Sioux Center, IA USA  
51250-2120

(712) 722-4868  
Fax (712) 722-4779

**QUESTIONS?  
CALL CUSTOMER  
SERVICE  
1-800-248-3057  
[www.linkcmp.com](http://www.linkcmp.com)**

# LINK® MODEL “LB20”

Review the **Parts List** on **Page 3** to become familiar with the different components of the **LB20**. Be sure all items were included before beginning assembly.

**IMPORTANT:** Installation of the **LB20** will vary depending on what type of vehicle you have and how you have it set up. Due to variables in different vehicles, the fit of the **LB20** should be evaluated before beginning installation.

- A.** The **LB20** Ramp is shipped partially assembled. Complete the assembly of the **LB20** before beginning installation (See **FIG. 2** on **Page 3** for assembly details.) The bumper plate, latch, and keeper (Item #'s 26, 15 & 16) can be installed on either side of the ramp depending on user preference.
- B.** Before starting installation, place the **LB20** in position and check all clearance issues. Be sure there is adequate clearance between the **LB20** and the van components (doors, door opening, etc.) Remember: You will need access to both the ramp handle (Item #23) and the lever assisted latch (Item #15.)
- C.** Once positioned, locate 4 holes on the mount plate (Item #25) that when drilled will clear fuel tank, frame, exhaust, and other components under the floor of the van. Mark the 4 holes to be used for mounting the **LB20**. Set aside the ramp and the mount plate. **Important: Before drilling, double check that these holes are accessible and will not damage important van components. Check under van to ensure no damage will occur in that area.**
- D.** Drill holes.
- E.** Remove the ramp from the mount plate (Item #25) and bolt the mount plate in place using the supplied fasteners (Item #'s 2, 10 & 13.) (See **Page 3** for details.)
- F.** Attach the ramp and confirm smooth operation and clearances.

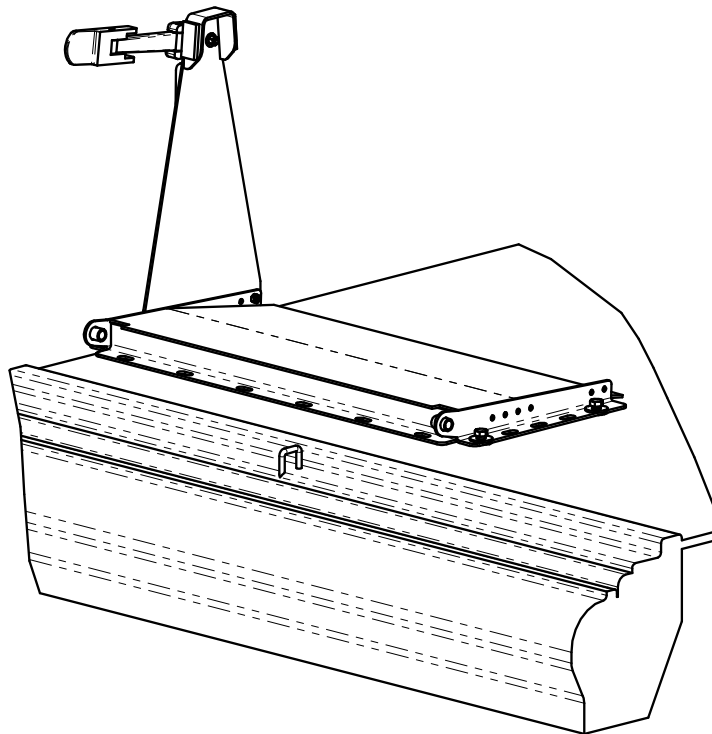

**FIG. 1**

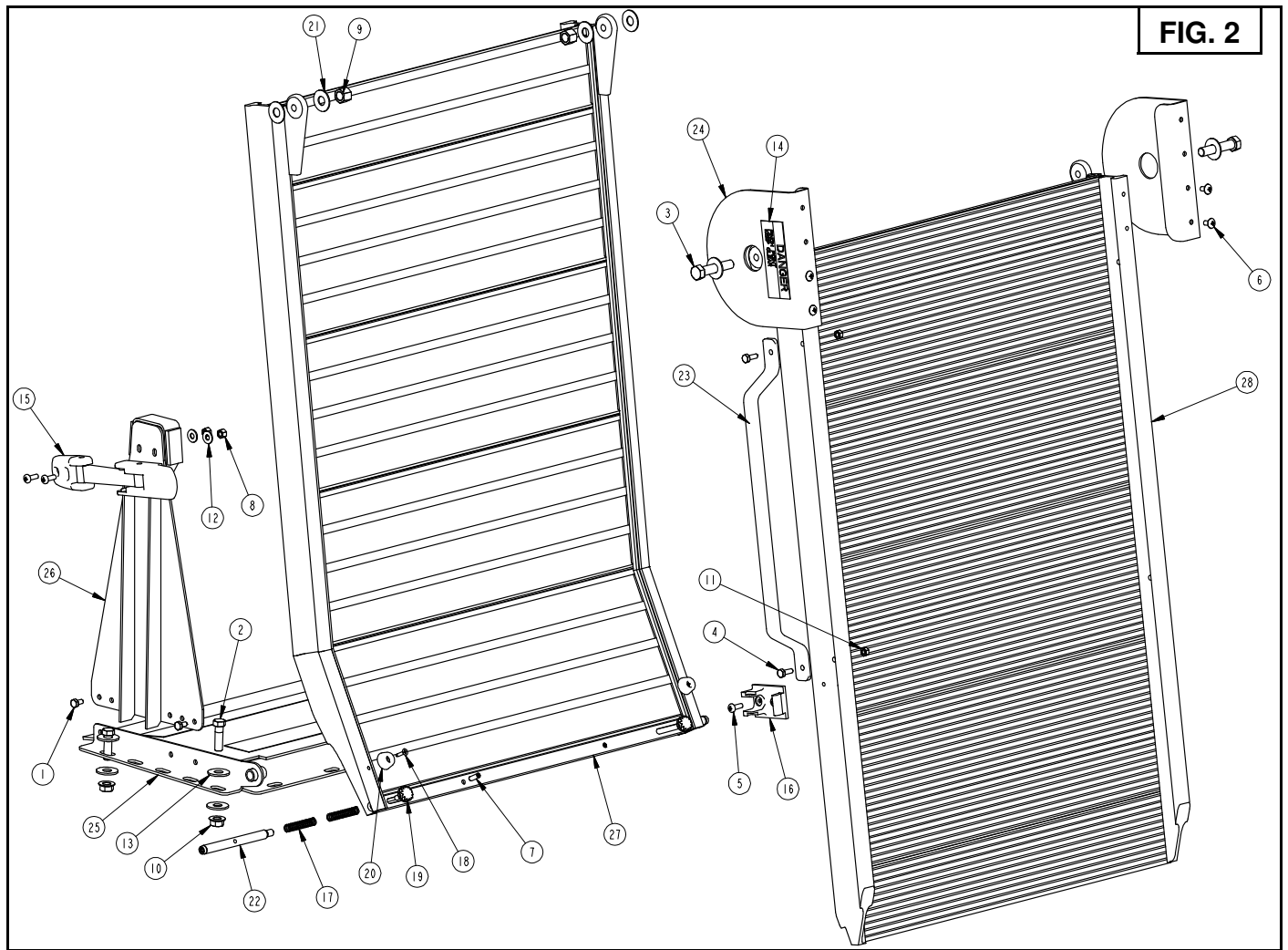

**FIG. 2**

## LINK® MODEL "LB20" PARTS LIST

ITEM	PART #	DESCRIPTION	QTY	ITEM	PART #	DESCRIPTION	QTY
1	1401-0804	1/4 X 1/2 UNC HEX CAP SCR (GR 5)	2	15	1500-0913	AEROLATCH-LEVER ASSISTED (LATCH ONLY)	1
2	1401-1412	7/16 X 1 1/2 UNC HEX CAP SCR (GR 5)	4	16	1500-0914	KEEPER-AEROLATCH	1
3	1401-1620	1/2 X 2 1/2 UNC HEX CAP SCR (GR 5)	2	17	1501-0001	COMPRESSION SPRING	4
4	1409-0806	1/4 X 3/4 UNC HEX CAP SCR, SS	2	18	1506-0041	#10 X 3/4, PHIL FLAT HEAD TAPPING SCREW	2
5	1442-0806	1/4 X 3/4 UNC PAN HD PH MACH SCR, ZINC	4	19	1507-0209	PLASTIC FLUTED KNOB, 1/4-20 X 9/16	2
6	144C-0804	1/4 X 1/2 UNC TRUSS HD PH MACH SCR, SS	4	20	1507-0403	RUBBER-BUMPER, 1.00 O.D. X .28	2
7	1450-0806	ROLL PIN, 1/4 X 3/4, PLAIN FINISH	2	21	1508-0112	WASHER-PLASTIC, .53 ID X 1.25 OD X .063 THK	6
8	1478-0800	1/4 UNC HEX NYLOCK NUT (GR B)	2	22	7000-0034	BOLT-HINGE ARM	2
9	1478-1600	1/2 UNC HEX NYLOCK NUT (GR B)	2	23	7850-0004	HANDLE-LB10	1
10	1480-1400	7/16 UNC SERRATED FLANGE NUT	4	24	7850-3005	GUARD-PINCH POINT	2
11	1484-0810	1/4 UNC HEX CTR LOCK NUT, SS	3	25		PLATE-MOUNT, REAR	1
12	1487-0800	1/4 TYPE A PLAIN WASHER	2	26	7851-2000	PLATE-BUMPER	1
13	1487-1400	7/16 TYPE A PLAIN WASHER	8	27		DECK-UPPER	1
14	1500-1311	DECAL-PINCH POINT	2	28		DECK-LOWER	1



*Link Mfg. Ltd.*  
*223 15th St. N.E.*  
*Sioux Center, IA USA*  
*51250-2120*